

NOTES:

1. INTERPRET DRAWING IN ACCORDANCE WITH ANSI Y14.5M-1982.
2. MATERIAL: USE ASTM A36 OR EQUIVALENT WITH 30 KSI YIELD STRENGTH.
3. REMOVE BURRS AND BREAK ALL SHARP EDGES.
4. ALL MACHINED SURFACES $\sqrt{125}$ UNLESS OTHERWISE NOTED.
5. FINISH: FINISH A36 STEEL WITH A NICKEL PLATE.
6. INK STAMP PART NUMBER ON ANY CONVENIENT FLAT SURFACE.

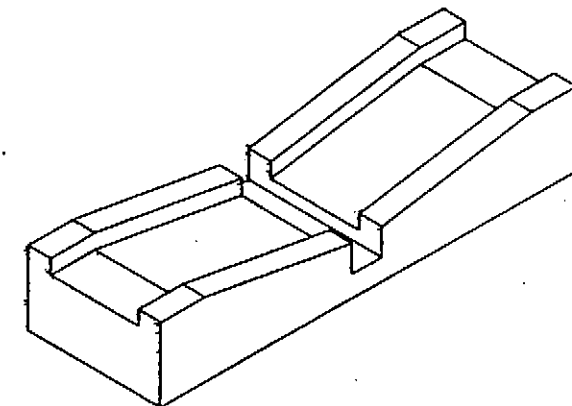
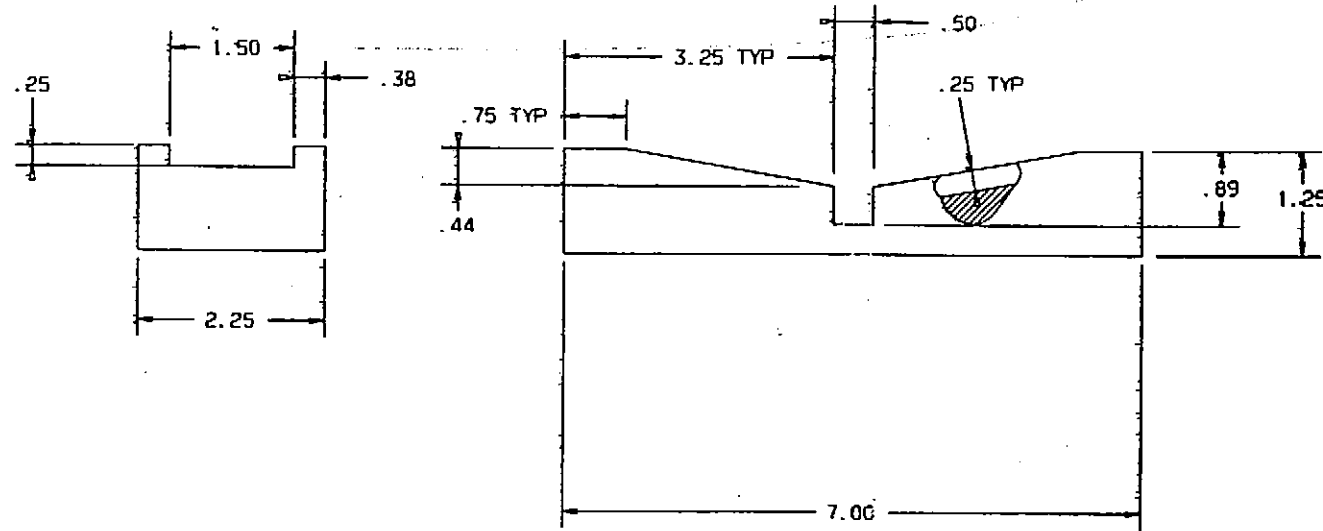

REVISED		DATE	APPROVED

JOB P. T. NUMBER

APPVL. SIGNATURES DATE

DRAWN BY	
CHECKER	
STRESS	
WEIGHTS	
THERMO ENGR	
MATL	
CAST/FORG	
CMPNT	
OPTIC	
HUMAN FAC	
SAFETY	
DYN/PROD SUPPT	
GR ENGR	
PROJ ENGR	
MFG ENGR	
QUAL ENGR	
PROGRAM APPROVAL	

ENGR

CHKR

CUSTOMER APPROVAL

C. O. C. USE ONLY

REC'D	DATE	INIT
FILE		
DELETE		
VERIFY		

ASTM
ASTM INTERNATIONAL

© ASTM International
100 Barr Harbor Drive, PO Box C700
West Conshohocken, PA 19428-2959
ASTM Designation: **D 3410**
ASTM Stock Number: **ADJD3410-E-PDF**
2021

QUANTITY/DRAWN NO.	REV. NO.	PROJ. NO.	DS	PART OR IDENTIFYING NO.	PL	SPECIFICATION OR DOCUMENT NO.	MONUMENTATION OR DESCRIPTION	STN	NOTE	END ITEM	PROJ. THRU	EFFECTIVITY

<p>SEE ENGINEERING RECORDS</p> <p>DATE SPECIFIED SPECIFIED OVERSIZES</p> <p>FRAC-TIONS</p> <p>DECIMALS</p> <p>INCHES</p> <p>MM</p> <p>IN</p> <p>1/8" 1/4" 3/8" 1/2" 5/8" 3/4" 7/8" 1"</p>	<p>CONTRACT NO.</p> <p>DRAWN BY</p> <p>CHECKER</p> <p>BY SHOP</p> <p>PROGRAM APPROVAL</p> <p>CUSTOMER APPROVAL</p>	<p>MARTIN MARTH CORPORATION</p> <p>POST OFFICE BOX 5437, ORLANDO, FLORIDA 32855</p> <p>ALIGNMENT FIXTURE</p> <p>SIZE</p> <p>PROJ. NO.</p> <p>DWG. NO.</p> <p>79966741</p> <p>SCALE 1/1</p>
---	--	--

